

HOK®

UNDERCARRIAGE PARTS



厦门鹭鸿盛贸易有限公司

XIAMEN LUHONGSHENG TRADING CO.,LTD

ADD: Room 414-2, No.777 Xinglong Road, Huli District, Xiamen, Fujian, China

Phone: +86 13159211907(whatsapp) +8618060568859(whatsapp)

E-mail: sunny.guo@digopas.com sales2@digopas.com

Web: www.hokparts.com



sunny.guo WhatsApp



Lex WhatsApp

泉州市克鲁铂重工机械有限公司

QUANZHOU KLUBO HEAVY INDUSTRY MACHINERY CO.,LTD

ADD: Factory Building 6, No. 1 Shunhe Road, Photovoltaic Base, Xiamei Town, Nan'an City, Quanzhou, Fujian, China

Phone: +86 13506096088(whatsapp)

E-mail: guodongmei28@hotmail.com

Web: www.hokparts.com



icelnguo WhatsApp



添加微信好友

工程机械零部件研发及制造

Manufacturing Of Construction Machinery parts



Track Roller | Top Roller | Sprocket | Front Idler | Track Link

克鲁铂重工

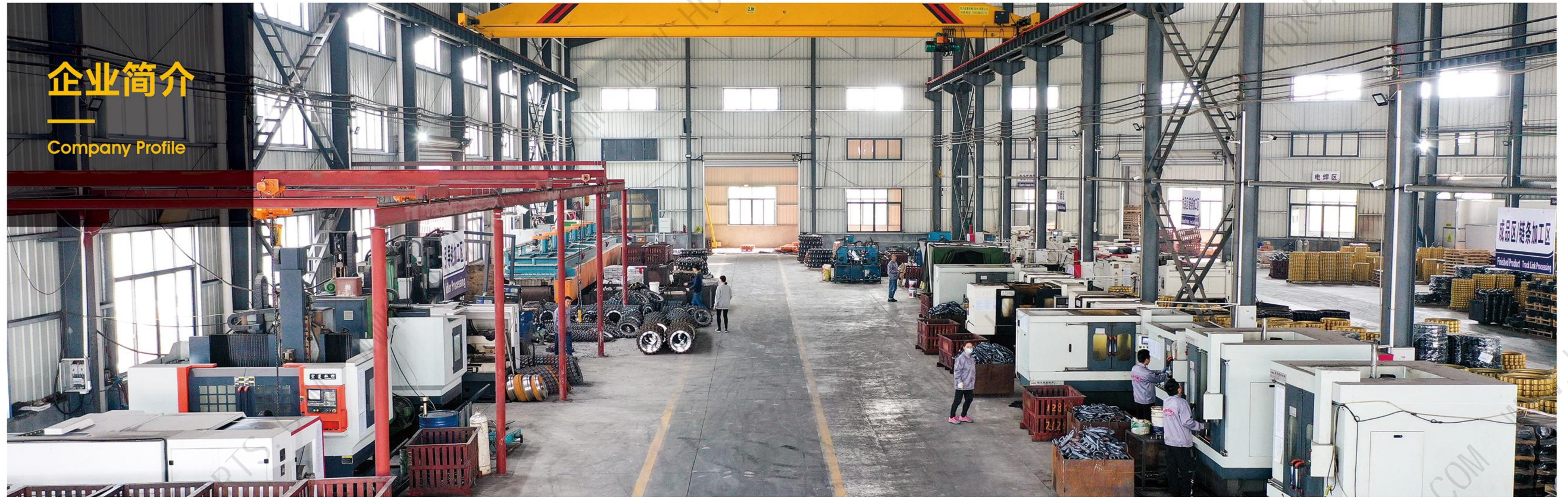

企业简介

Company Profile

100+

公司服务客户
数量超过100家

厦门鹭鸿盛贸易有限公司于2014年成立，位于美丽的港口城市厦门，我们是一家十几年来专注于工程机械零件研发、制造和贸易的企业，供应履带式挖掘机、推土机底盘成套设备，我们的使命是创您所需，为您传递更高价值，实现最优的商业效益。

为了更好的控制成本和质量，我们在2019年创办了自己的工厂-泉州市克鲁铂重工机械有限公司。主要供应履带式底盘系统更换零件，包括履带链条，支重轮、托链轮、驱动轮、引导轮、涨紧装置总成、铲斗、斗齿和适配器，及各种液压油缸、销、轴、套高强度螺栓、齿轮等机械零部件。秉承“质量为根，诚信为本”的原则，不断改进我们的生产技术，凭借着工程师30年的制造经验和一流的生产设备和先进的检测手段，实现物美价廉。我们的产品以我们的高质量和良好的服务赢得了世界各地的良好声誉。

作为一家深受市场认可的工程机械制造商，我们提供一站式解决方案，满足您在标准和定制化产品中的多样化需求，以提高您的市场竞争力。我们的产品广泛适用于卡特彼勒、小松、日立、神钢、住友、斗山大宇、沃尔沃等世界知名工程机械品牌。我们也欢迎各种定制和批量订单。我们的销售代表将与您一起商计最高性价比的解决方案，也竭诚欢迎您加入鹭鸿盛贸易队伍，共创双赢合作。

30+

多名30年研发制造
经验的工程师

10+

为国内外十多个知名品牌
提供产品配套服务

Xiamen Luhongsheng Trading Co., Ltd was established in 2014 and is located in the beautiful port city of Xiamen. We are an enterprise focusing on the R&D, manufacturing and trade of construction machinery parts for more than ten years. We supply the complete set of bulldozer and excavator spare parts. our mission is to deliver more value you need and deliver higher value for you, and achieve the best commercial benefits.

In order to better control the cost and quality, we founded our own factory in 2019 - Quanzhou Klubo Heavy Industry Machinery Co., Ltd. Mainly production track type chassis system replacement parts, including track chain, track rollers, carrier rollers, sprockets, idlers, track adjuster assy, buckets, bucket teeth and adapters, and various hydraulic cylinders, pins, shafts, sleeves High-strength bolt, gears and other mechanical parts. Adhering to the principle of "quality is the root, honesty is the foundation", we constantly improve our production technology, relying on the engineers' 30 years of manufacturing experience, first-class production equipment and advanced testing methods to achieve high quality and low price. our products have won the good reputation all over the world by our high quality and good services.

As a well-recognized construction machinery manufacturer in the market, we provide one-stop solutions to meet your diverse needs in standard and customized products to improve your market competitiveness. Our products are widely used in Caterpillar, Komatsu, Hitachi, Kobelco, Sumitomo, Doosan Daewoo, Volvo and other world-renowned construction machinery brands. Undertake all kinds of customized and bulk orders, Our sales representatives will discuss with you the most cost-effective solution, and sincerely welcome you to join Luhongsheng's trading team to create a win-win cooperation.

10+

出口东盟、南亚、
中东、欧洲等十多个国家



Exported to ASEAN, South Asia
More than 10 countries in the
Middle East and Europe

生产设备

Production Equipment

Xiamen Luhongsheng Trading Co., Ltd.

工程机械零部件研发及制造



热处理车间
Heat Treatment Workshop



链条加工车间

Track Link Processing Workshop



引导轮加工车间

Front Idler Processing Workshop

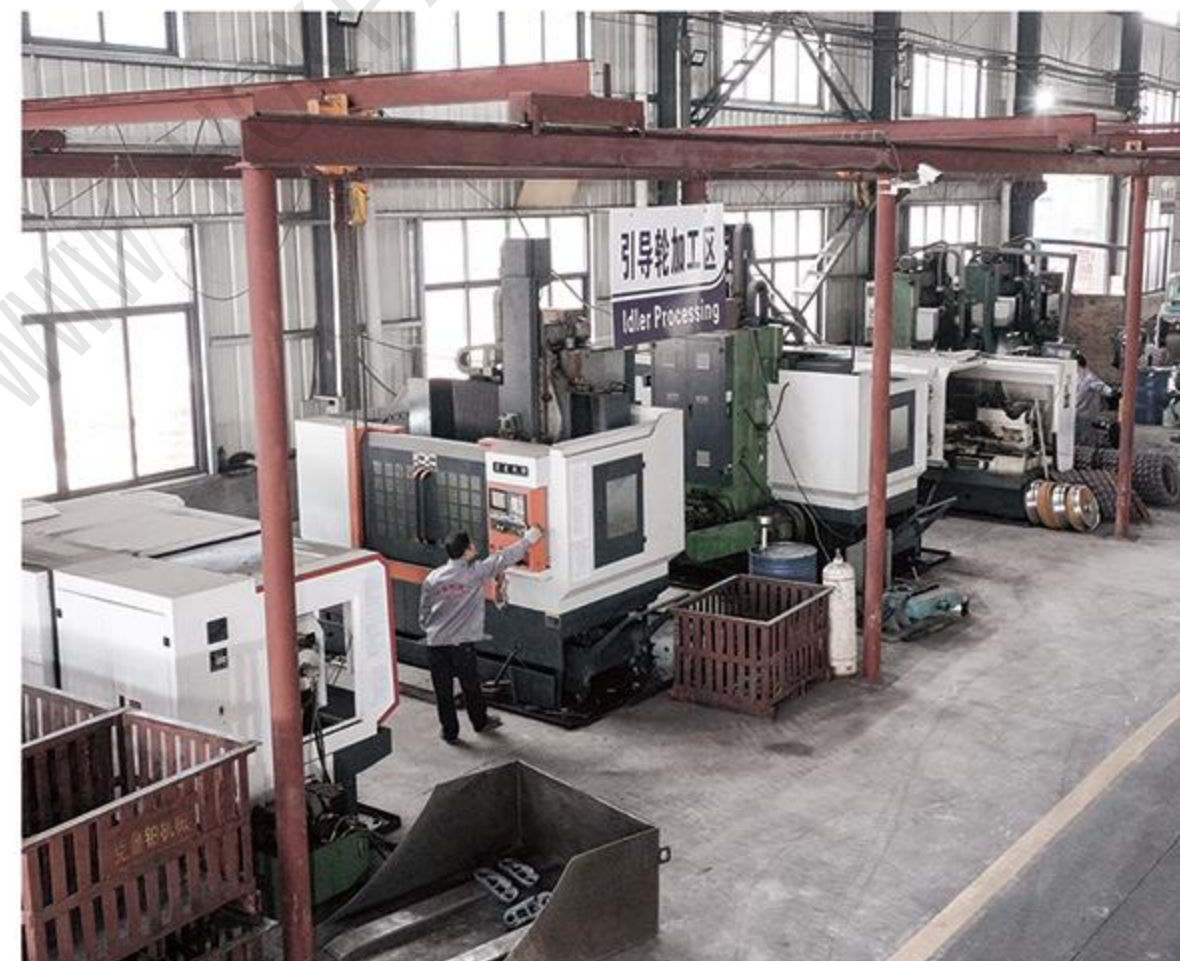

支重轮/拖链轮加工车间

Track Roller / Carrier Roller Processing Workshop



驱动齿圈加工车间

Sprocket Processing Workshop





检验设备

Production Equipment

Xiamen Luhongsheng Trading Co., Ltd.
工程机械零部件研发及制造

- ① 碳硫分析仪
Carbon Sulfur Analyzer
- ② 洛氏硬度计
Rockwell Hardness Tester
- ③ 金相检测
Metallographic Examination
- ④ 冲击试验
Impact Test
- ⑤ 拉力试验
Tensile Test



Track Link Assy

链轨总成



产品介绍 INTRODUCTION

锻造：采用高科技，自动操作确保产品的高度均匀性。

热处理：工艺结束后，使用激光探测器进行100%检测，提高了生产效率以及结果的一致性。

线切割：确保高质量的分体式主链节。

液压机装配：装配后的连杆保持恒定的间隙。

CNC 精密加工切割

100% 激光探测检测

40Mn2 优质钢材

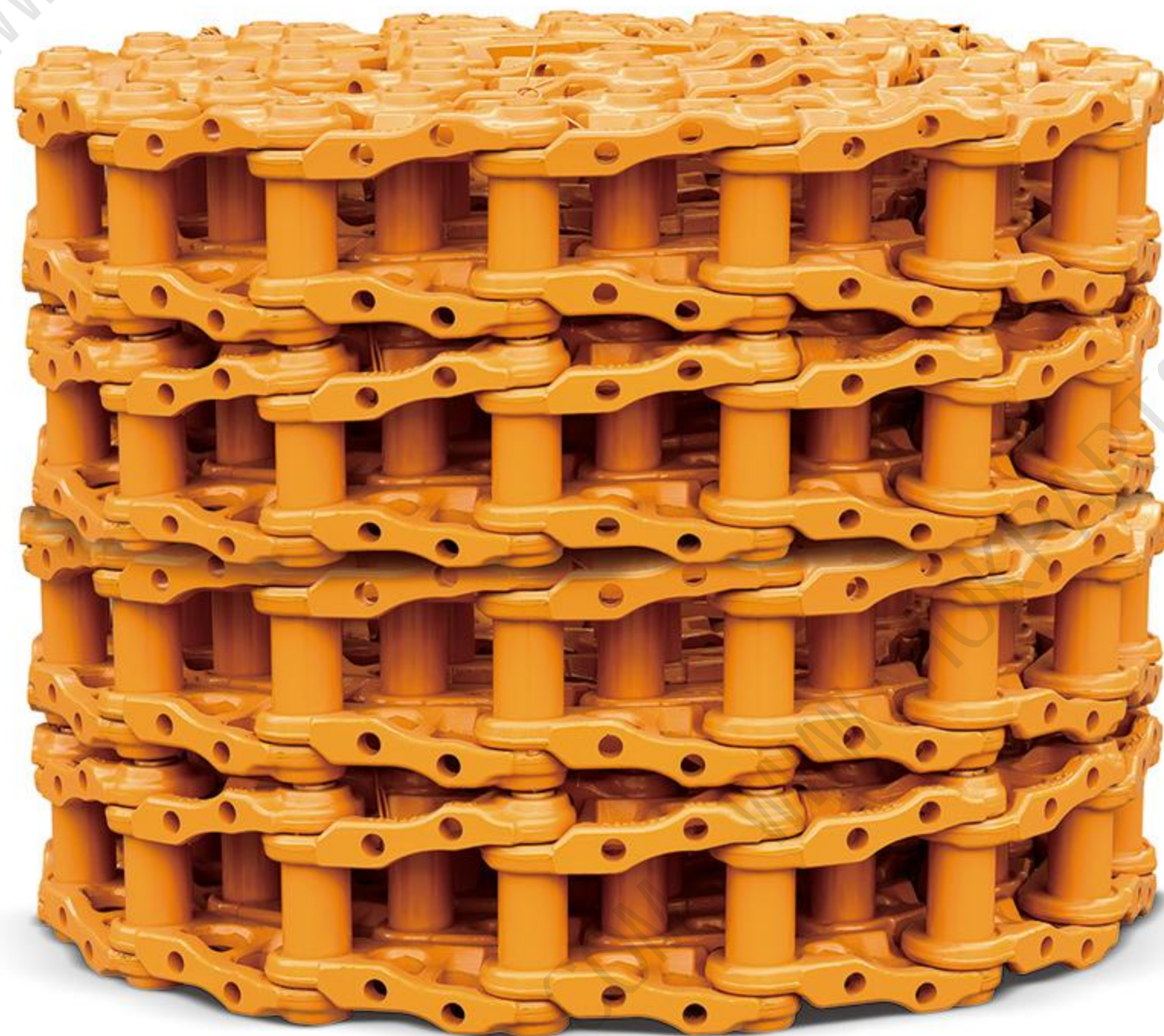

OIL CHAIN ASSEMBLY

油链总成



TRACK SHOE

链板



TRACK LINK

链片



TRACK LINK ASSEMBLY

Forging : With high technology, automatic operation ensures high level of homogeneity in the product.

Heat Treatment : After the process, laser detector is used for the 100% Inspection.

Mechanical Complex Machine : Increased production efficiency as well as the uniformity of outcome.

Wire Cutting : Assures high quality Split Master Links.

Hydraulic Press Assembling Machine : Assembled links maintain constant clearance.

Every Model Should Be Controlled By Quality Control Plan.

all Process Should Be Followed Byworking Standard.

all Models Should Be Inspected By Inspection Check Sheets.

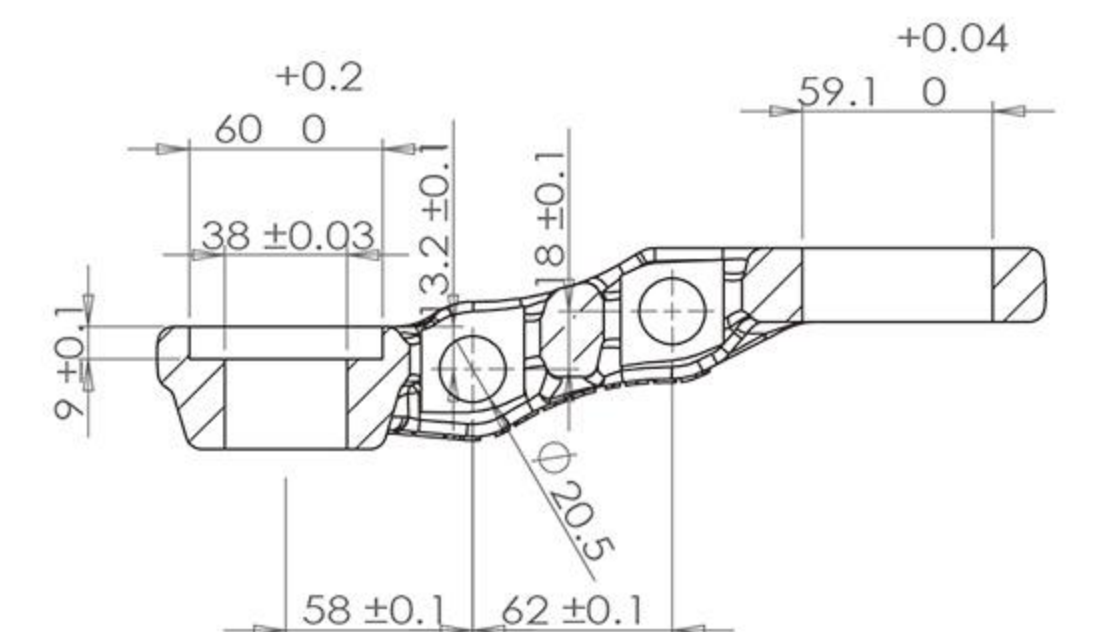
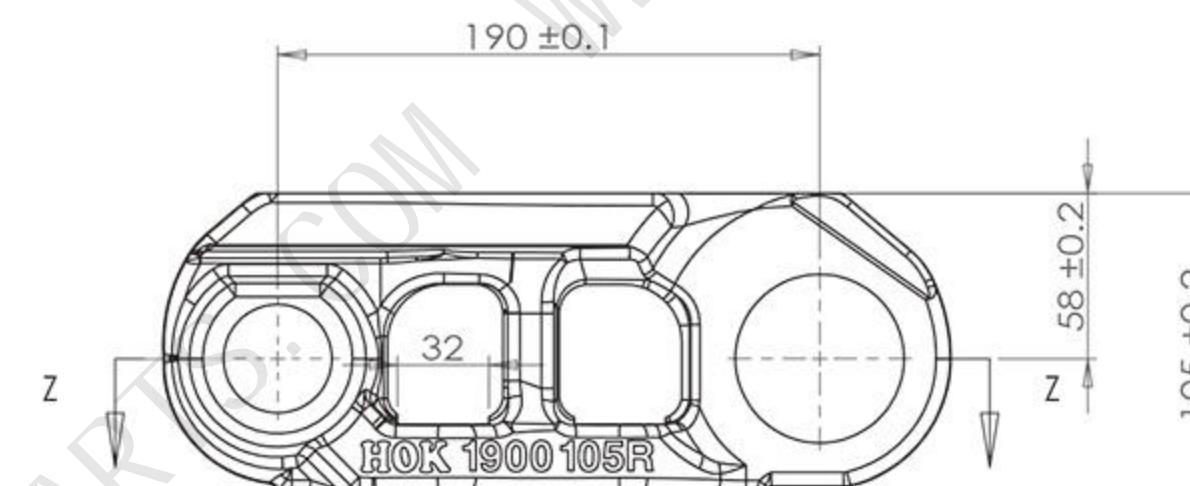

Track Roller

支重轮



产品介绍 INTRODUCTION

轮体：采用淬透性好的40Mn2圆钢材料经锻造而成；调质+中频表面淬火的热处理工艺，保证其强度和耐磨性能。

轴：采用45#圆钢材料，调质+中频表面淬火的热处理工艺，表面硬度HRC52-60，硬化层深度3-6mm，综合性能优良。

浮动油封：采用高铬高钼合金。硬度HRC65-72，工作面粗糙0.1uM-0.2uM。

O形圈：采用丁烯和丙烯腈经共聚而成的丁睛橡胶原料生产而成，具有更好的耐油性和耐高温性。

40Mn2 圆钢材料经锻造而成

HRC52-60 表面硬度

0.1uM 工作面粗糙度

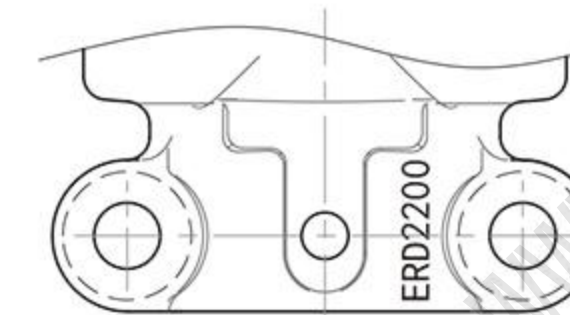
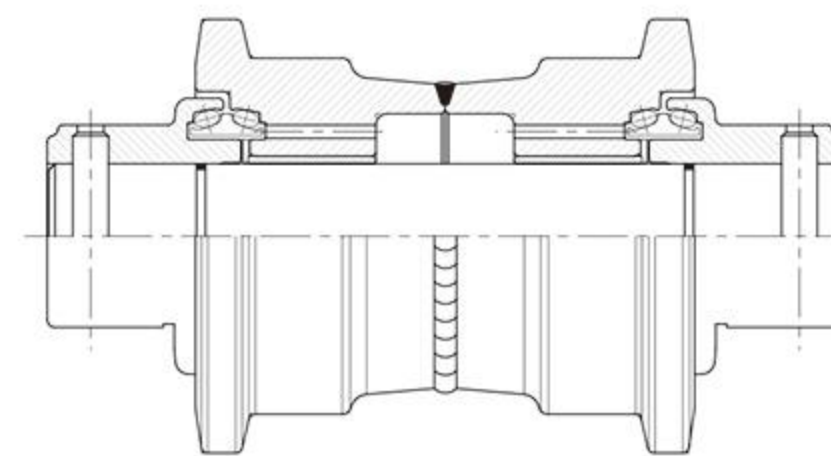

Wheel body: forged from 40Mn2 round steel with good hardenability; The heat treatment process of quenching and tempering+medium frequency surface quenching ensures its strength and wear resistance.

Shaft: 45 # round steel material, heat treatment process of quenching and tempering+medium frequency surface quenching, surface hardness HRC52-60, depth of hardened layer 3-6mm, excellent comprehensive performance.

Floating oil seal: made of high chromium and high molybdenum alloy. Hardness HRC65-72, working surface roughness 0.1uM-0.2uM.

O-ring: It is produced from butylene and acrylonitrile, which are copolymerized into butylene and acrylonitrile, and has better oil resistance and high temperature resistance.

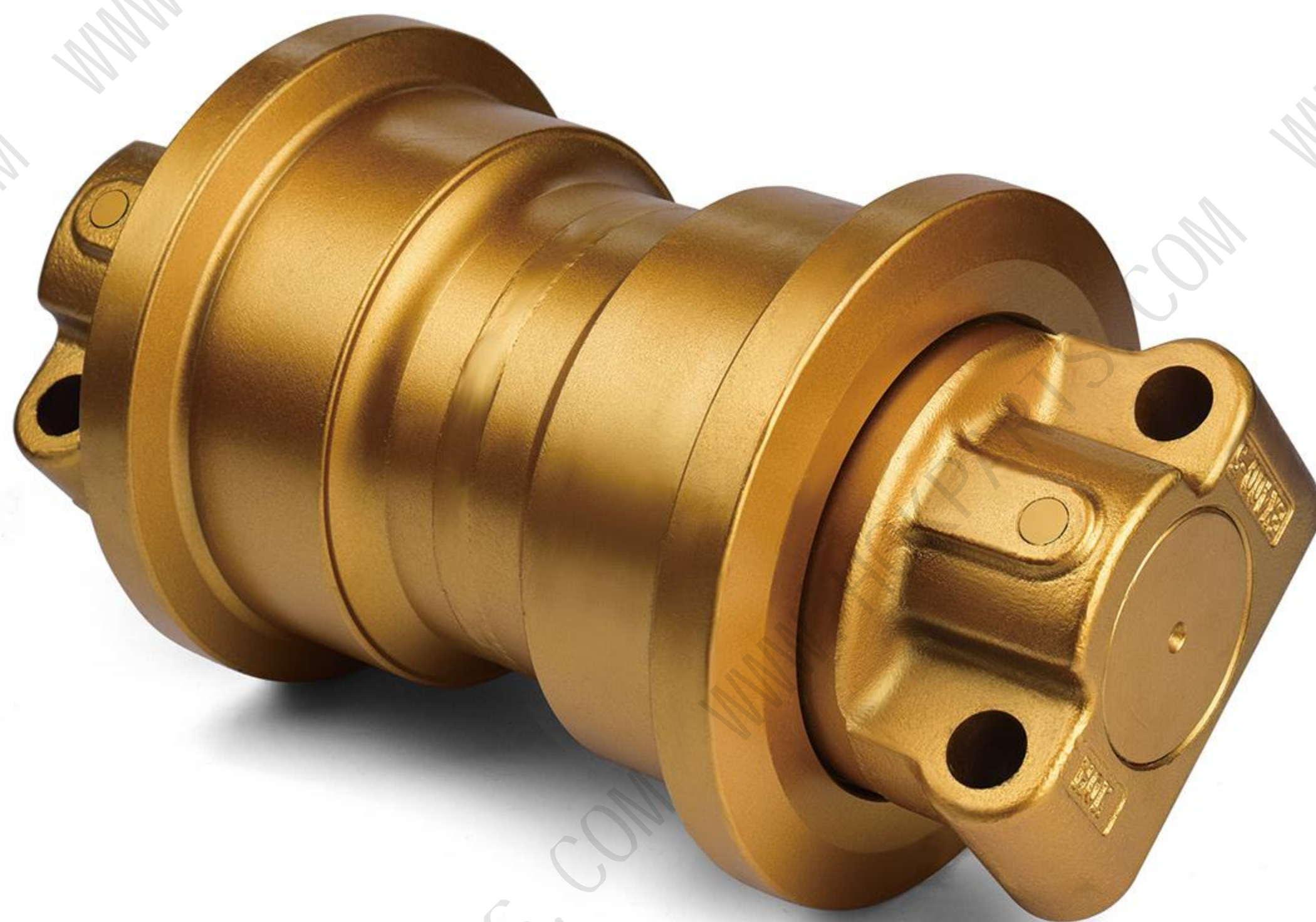

Carrier Roller

拖链轮



产品介绍 INTRODUCTION

轮体：采用淬透性好的40Mn2圆钢材料经锻造而成；调质+中频表面淬火的热处理工艺，保证其强度和耐磨性能。

轴：采用45#圆钢材料，调质+中频表面淬火的热处理工艺，表面硬度HRC52-60，硬化层深度3-6mm，综合性能优良。

浮动油封：采用高铬高钼合金。硬度HRC65-72，工作面粗糙0.1uM-0.2uM。

O形圈：采用丁烯和丙烯腈经共聚而成的丁睛橡胶原料生产而成，具有更好的耐油性和耐高温性。

40Mn2 圆钢材料经锻造而成

HRC52-60 表面硬度

0.1uM 工作面粗糙度

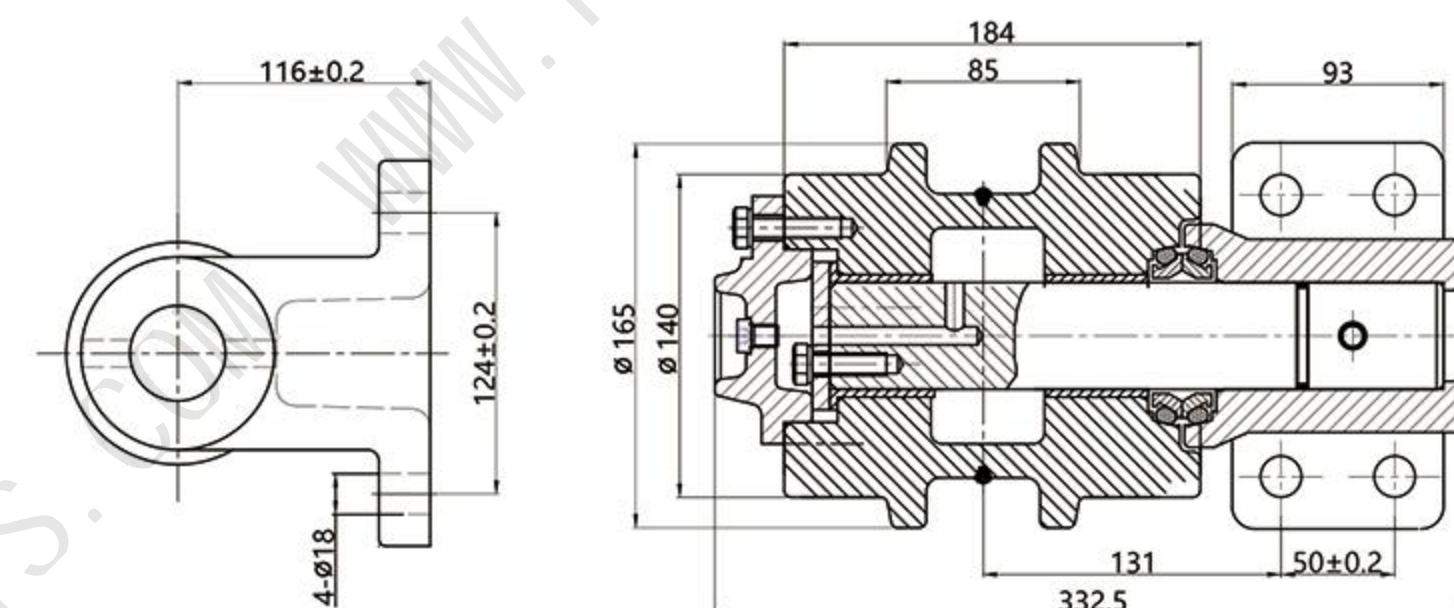

Wheel body: forged from 40Mn2 round steel with good hardenability; The heat treatment process of quenching and tempering+medium frequency surface quenching ensures its strength and wear resistance.

Shaft: 45 # round steel material, heat treatment process of quenching and tempering+medium frequency surface quenching, surface hardness HRC52-60, depth of hardened layer 3-6mm, excellent comprehensive performance.

Floating oil seal: made of high chromium and high molybdenum alloy. Hardness HRC65-72, working surface roughness 0.1uM-0.2uM.

O-ring: It is produced from butylene and acrylonitrile, which are copolymerized into butylene and acrylonitrile, and has better oil resistance and high temperature resistance.



Front Idler 引导轮



产品介绍 INTRODUCTION

采用优质合金钢，经整体锻造消除金属在冶炼过程中产生的铸态疏松等缺陷，优化微观组织结构。同时由于保存了完整的金属流线，具有较高的使用寿命。

达500多种尺寸规格可满足所有挖掘和其他履带式机械的配置需求，欢迎来图来样定制。可视化铸造技术的应用避免轮体存在铸造缺陷，提高机械性能。采用自主研发材料所生产的轮体经感应淬火后，抗负载性能和使用寿命都得到大幅度提高。

HRC50-58 表面硬度

ZG40Mn2 轮体材质

5mm-10mm 淬火深度



CASTING
铸造



FORGING
滚锻

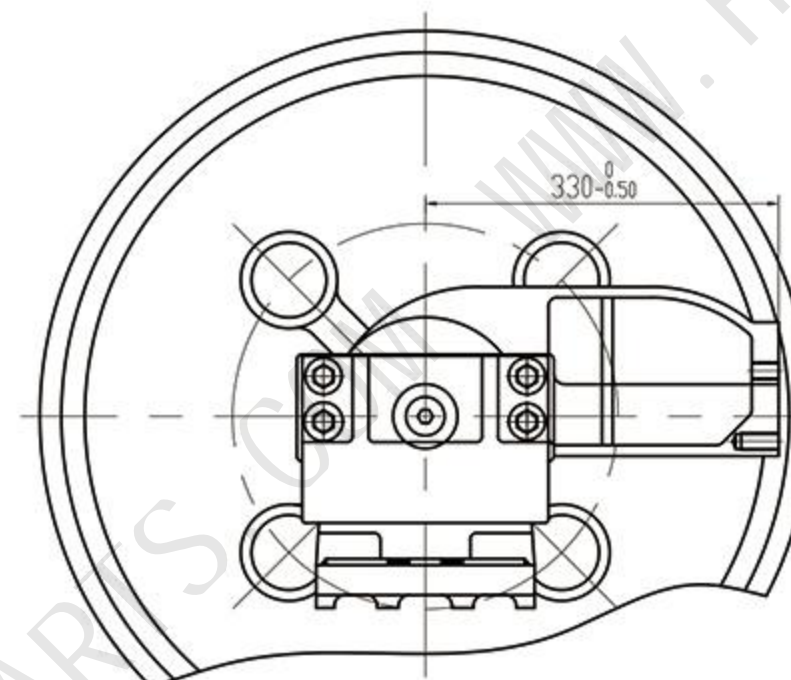
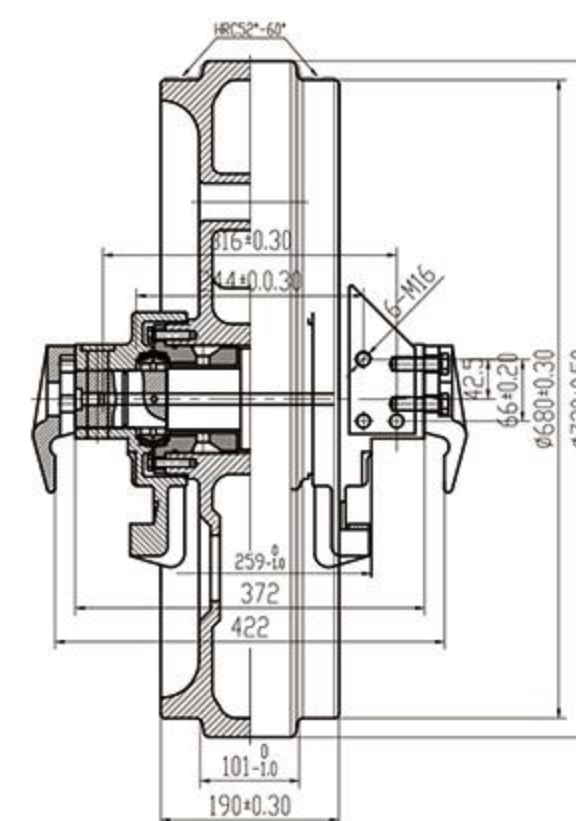

Adopt high quality alloy steel and integral forging, the as - cast porosity or other defect which products in metal smelting process are eliminated, optimize the microstructure, Meantime, the preservation of a complete metal streamline offers the long time product lifetime.

More than 500 types are available for all types of machine requirements, specification drawings or product samples are welcome too. The visual casting technology avoids the existence of product casting defects but improves mechanical properties. After self-developed induction quenching for Idler, the load resistance and service life are greatly improved.



Sprocket

驱动齿圈



产品介绍 INTRODUCTION

采用优质合金钢，通过碾环锻造工艺锻造代替铸造，保证金属纤维组织的连续性，使锻件的纤维组织与锻件外形保持一致，金属流线完整，保证零件具有良好的机械性能和更长的使用寿命。

淬火深度：齿根 6-10mm，齿顶 18-23mm

HRC48-58 表面硬度

ZG35Mn2 材质

18mm-23mm 淬火深度

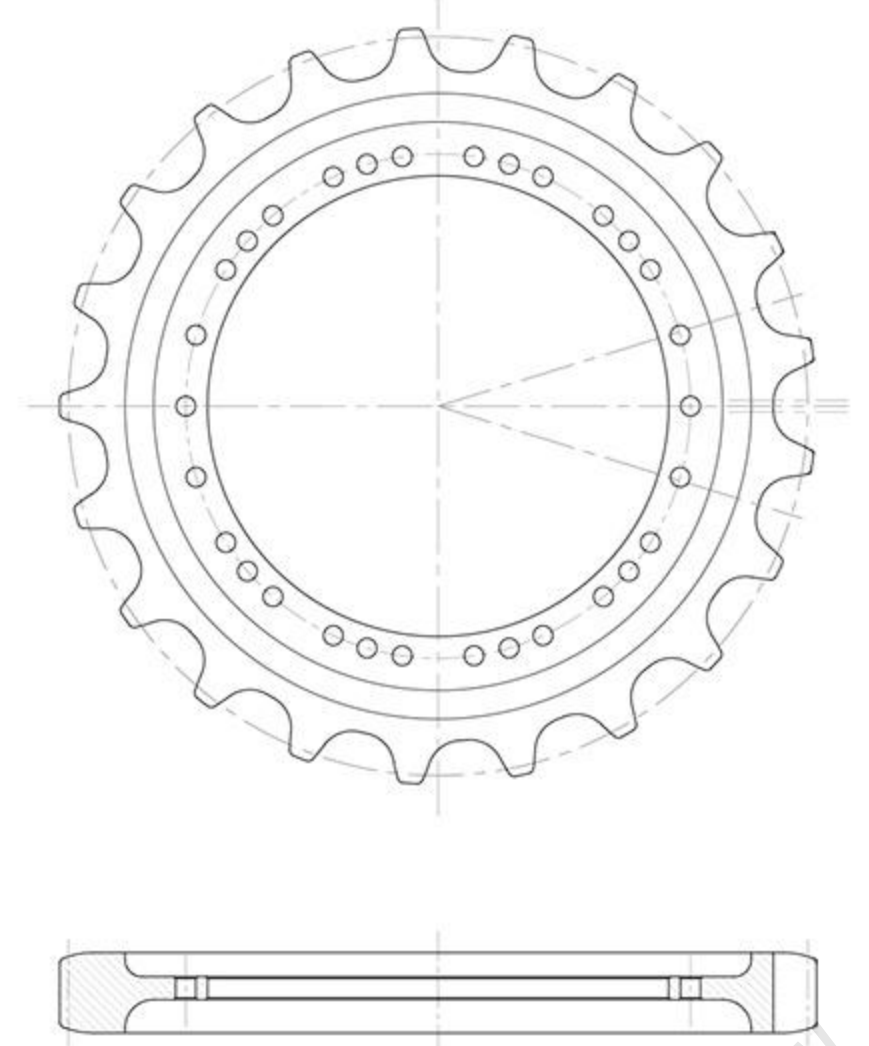

SEGMENT

齿块



The high-quality alloy steel is used, and the forging is replaced by the rolling ring forging process to ensure the continuity of the metal fiber structure, so that the fiber structure of the forging is consistent with the shape of the forging. The metal flow line is complete, ensuring that the parts have good mechanical properties and longer service life.

Quenching depth:
Root tooth 6-10mm
Rop tooth 18-23mm

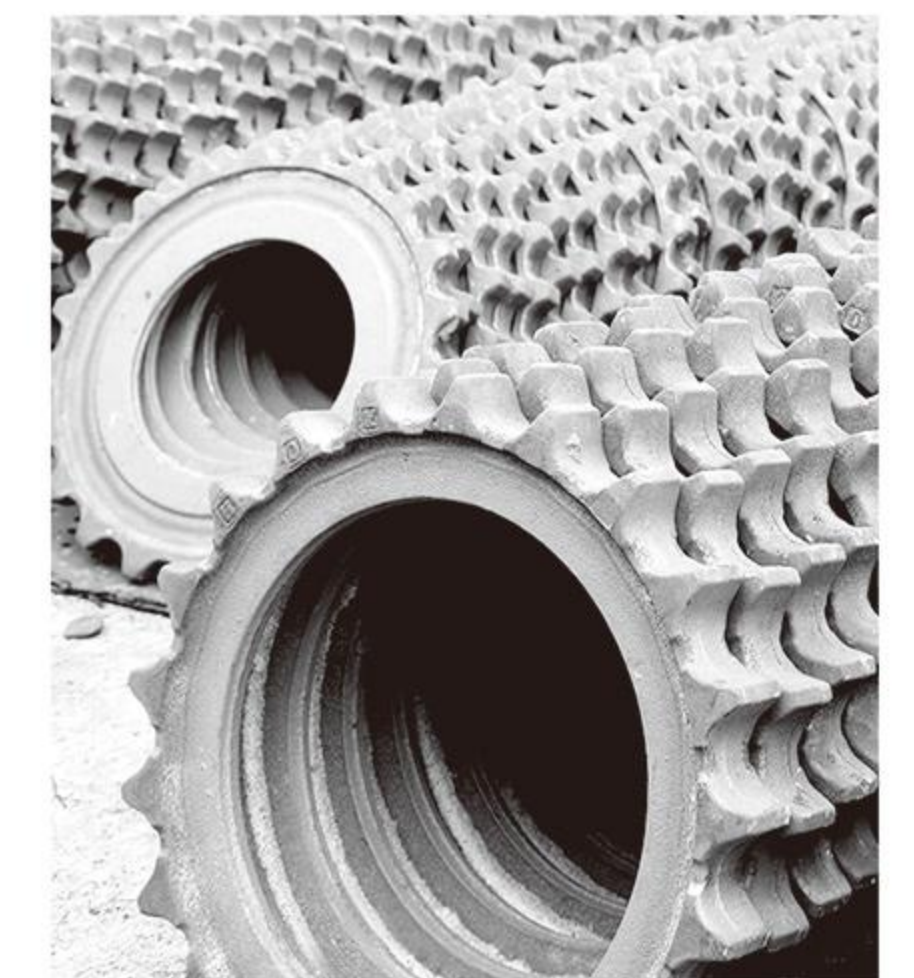

Other Series 其他系列

Xiamen Luhongsheng
Trading Co., Ltd.
工程机械零部件研发及制造



BOLT SERIES 螺栓系列



Bucket Teeth
斗齿



Bucket Adapter
斗根



Bucket Pin
斗轴



Bucket Bushing
斗轴套



Cutting Edge / End Bits
刀角、刀板



Ridge Buster/Scarifier
松土器



Spring Plate
弹簧座



Track Adjuster Assy
涨紧总成



Tooth Pin
斗齿销



Arm Bushing
马拉头



Bucket Plinth
斗耳



Track Guard
护链架



H Link
千秋架



I-Link
连杆